



System No. HW-D-1021

October 21, 2015

Assembly Rating—3 Hr

L Rating at Ambient—Less than 1 CFM/Lin Ft

L Rating at 400°F—Less than 1 CFM/Lin Ft

Nominal Joint Width— 3-1/2 In.

Class II Movement Capabilities—15% Compression or Extension

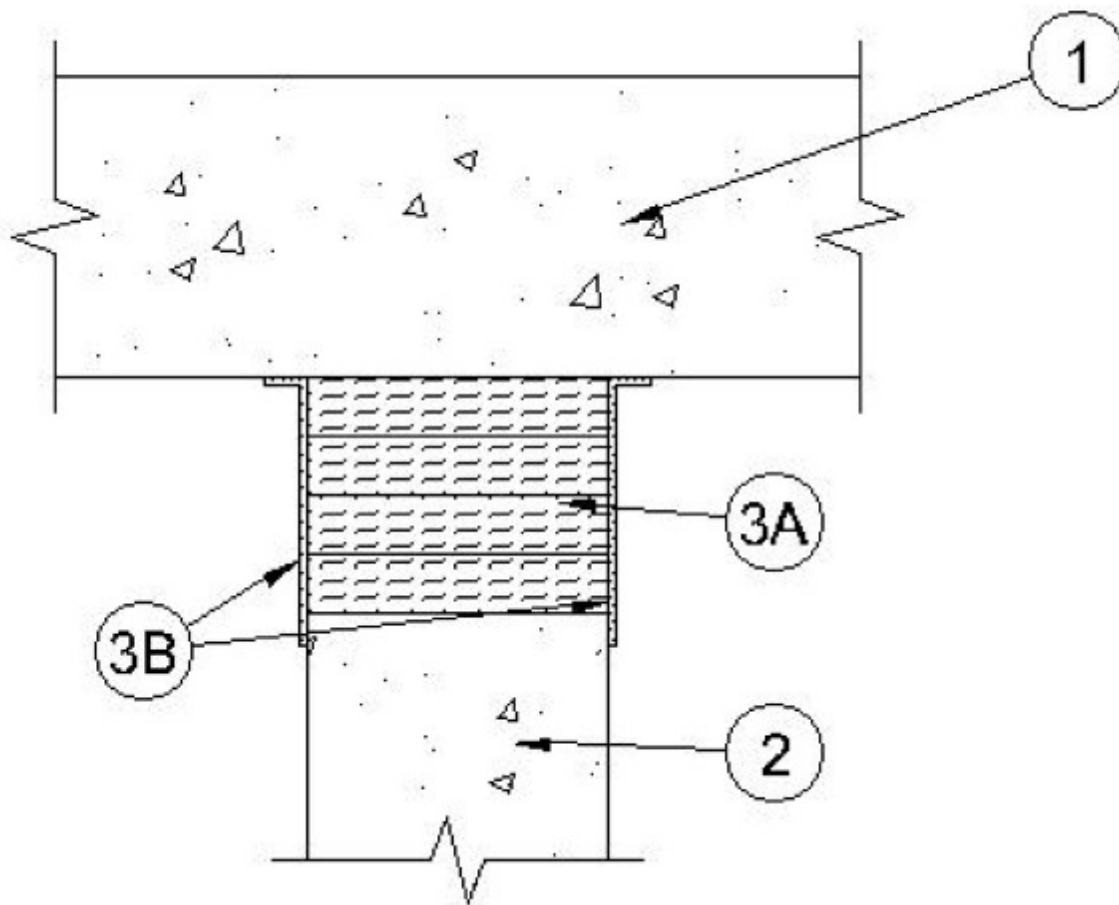

1. Floor Assembly — Min 4-1/2 in. (114 mm) thick reinforced lightweight or normal weight (100 - 150 pcf or 1600-2400 kg/m³) structural concrete. Floor may also be constructed of any min 6 in. thick UL Classified hollow-core **Precast Concrete Units*** .

See **Precast Concrete Units** (CFTV) category in the Fire Resistance Directory for names of manufacturers.

2. Wall Assembly — Min 4-1/2 in. (114 mm) thick reinforced lightweight or normal weight (100 - 150 pcf or 1600-2400 kg/m³) structural concrete. Wall may also be constructed of any UL Classified **Concrete Blocks*** .

See **Concrete Blocks** (CAZT) category in the Fire Resistance Directory for names of manufacturers.

3. Joint System — Max separation between bottom of floor and top of wall (at time of installation of joint system) is 3-1/2 in. (89 mm). The joint system is designed to accommodate a max 15 percent compression or extension from its installed width. The joint system shall consist of the following:

A. **Forming Material*** — Min 4 pcf (64 kg/m³) mineral wool batt insulation installed in joint opening as a permanent form. Pieces of batt cut to min width of 4 in. and installed edge-first into joint opening, parallel with joint direction, such that batt sections are compressed min 42 percent in thickness and that the compressed batt sections are recessed from each surface of the wall as required to accommodate the required thickness of fill material. Adjoining lengths of batt to be tightly-butted with butted seams spaced min 24 in. (610 mm) apart along the length of the joint.

INDUSTRIAL INSULATION GROUP L L C — MinWool-1200 Safing

JOHNS MANVILLE — Safing

ROCK WOOL MANUFACTURING CO — Delta Safing Board

ROCKWOOL MALAYSIA SDN BHD — SAFE

ROXUL INC — SAFE Mineral Wool

THERMAFIBER INC — SAF

B. **Fill, Void or Cavity Material*—Sealant** — Min 1/8 in. (3.2 mm) wet thickness of fill material applied within the joint, flush with each surface of wall and lapping a min 1/2 in. (13 mm) onto the bottom surface of the floor and each side of wall.

RECTORSEAL — FlameSafe FS3000, Metacaulk 1200, 1500 or Biostop 750, 800 Spray

* Indicates such products shall bear the UL or cUL Certification Mark for jurisdictions employing the UL or cUL Certification (such as Canada), respectively.