

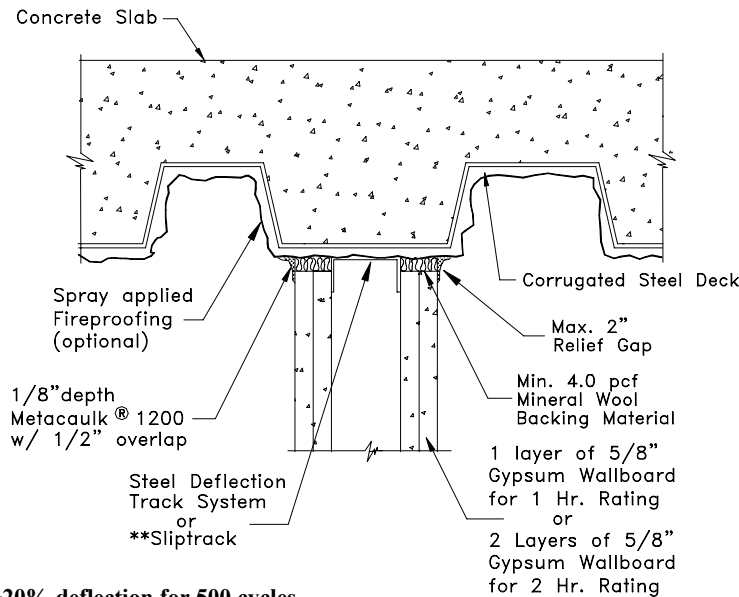

System No.  
HWD0221

# metacaulk®

1200GW-12  
Joint/Gap  
1 or 2 Hr Assembly Rating



Tested as per UL 2079 at ±20% deflection for 500 cycles

SYSTEM CONFIGURATION INFORMATION									
PRODUCT(S)			GAP or JOINT SIZE		SUBSTRATES SPACING	ADDITIONAL INSTALLATION MATERIALS AND AIDS	BACKING MATERIAL		UL2079 ASSEMBLY RATING
FILL MAT'L	MIN. THICK.	OTHER	MAX.	MIN.			TYPE	DEPTH	
1200	1/8" both sides	none	up to 2" relief gap	N/A	gypsum wallboard to steel decking or optional fireproofing	none	mineral wool insulation 4.0 pcf minimum	full wall thickness	1 or 2 hours

\* Type MK-6 as manufactured by W.R. Grace & Co.

\*\* Brady Sliptrack Systems

## INSTALLATION INSTRUCTIONS

These instructions are for the installation of Joint/Gap firestop system 1200GW-12 in a relief joint below a maximum 3" steel deck in minimum 2 1/2" wide steel stud, fire rated gypsum wallboard partitions as listed by Underwriters Laboratories Inc. Refer to above drawings and System Configuration Information for component details.

### Step Procedure

- Clean all surfaces in gap area to remove loose debris, dirt, oil, wax, grease, old caulking, etc.
- Properly install 1 or 2 layers of 5/8" type 'X' gypsum boards and position to a maximum of 2" below steel deck.
- Install backing material by firmly packing a minimum 4.0pcf mineral wool insulation fitted in opening between steel decking and top of gypsum wallboard. Compress mineral wool a minimum 33%.
- Spray, trowel and/or brush Metacaulk® 1200 firestopping sealant to a minimum 1/8" depth bridging the steel deck or optional fireproofing to the gypsum wallboard and extending a minimum 1/2" onto the steel deck and gypsum wallboard or a minimum 2" onto the optional fireproofing.

JOB NAME:

ARCHITECT:  
CUSTOMER:  
CUSTOMER ORDER NO:

CONTRACTOR:  
REPRESENTATIVE:  
REPRESENTATIVE ORDER NO:

RECTORSEAL  
2601 SPENWICK HOUSTON, TEXAS 77055

REVISION NUMBER: 092501  
SHEET NUMBER: OF